



# Romania Country Guide

elevate destinations

# Welcome to Romania!

In this document you will find information that will be useful during your journey to Romania. The information listed in this guide includes cultural guidelines, communication tips, health and safety recommendations, and so much more. Please note that all information specific to your trip, such as inclusions and exclusions, staff contact numbers, flight information, etc. is listed in your Online Trip Portal. For any questions unanswered by either the country guide or the online portal, please don't hesitate to reach out to an Elevate staff member.

## Table of Contents

<b>Know Before You Go</b>	<b>3</b>
Passport	3
Visa	3
Medical and Travel Insurance	3
Immunizations	4
Other Health Considerations	4
Medications	5
Safety Recommendations	5
Communications	6
Essential Travel Documents	6
Money	7
<b>In-country Info</b>	<b>8</b>
Time	8
Electricity	8
Water & Food Safety	9
Waste Disposal	9
Local Cuisine	9
Weather Conditions	10
<b>Cultural Considerations</b>	<b>10</b>
Language	11
Photography	12
Human Trafficking in Travel	12
Responsible Travel Tips	12

# Know Before You Go

## Passport

Travelers to Romania should ensure that the validity of their passports extends at least 6 months beyond the end of their intended stay, and should have at least 2 blank (unstamped) visa pages in their passport to enter the country. The last 2 amendment pages are unacceptable for visas and immigration stamps. Note that you will need to renew your passport if you are out of visa pages, as the State Department no longer provides additional pages. If you need to renew your passport, please do so as soon as possible.

## Visa

U.S. passport holders are not required to obtain a visa to enter Romania. With a valid U.S. passport, you can stay up to 90 days in the Schengen area for tourism or business during any 180-day period. You must wait an additional 90 days before applying to re-enter the Schengen area.

## Medical and Travel Insurance

Elevate Destinations will purchase emergency evacuation coverage for you. This policy covers emergency evacuations due to medical, political, or natural disasters for your trip dates. This policy also provides \$5,000 of emergency medical coverage. More details about this coverage can be found in your online trip portal.

This coverage does not include trip cancellation or interruption benefits and also does not cover pre- or post-trip days of travel booked outside of Elevate Destinations. We strongly suggest you purchase additional coverage to cover your non-refundable expenses in the event you need to cancel your trip or have additional expenses incurred on the trip.

Elevate strongly recommends purchasing additional travel and medical insurance and Cancel for Any Reason Coverage (CFAR) to cover trip related expenses. Please note that some CFAR insurance options are time-sensitive. Please be ready to purchase an insurance policy within 14 days of making your first trip payment.

Below are two insurance brokers that Elevate Destinations recommends.

- [USI Travel Insurance Services](#)  
Email: [info@travelinsure.com](mailto:info@travelinsure.com)  
Phone Number: (800) 937-1387
- Travel Insurance Center (Dan Drennen)  
Email: [dan@travelinsurancecenter.com](mailto:dan@travelinsurancecenter.com)  
Phone Number: (402) 343-3621

Guests may acquire medical insurance through USI, The Travel Insurance Center, or any other insurance company of their choosing. Elevate Destinations is not equipped to answer specific questions on insurance. Please contact the insurance broker or company for specific information.

#### **Smart Traveler Tip!**

Have electronic and paper copies of your passport in case something happens to it while you are traveling.

- Scan a copy of your passport and email it to yourself.
- Take a photo of your passport and save it to your phone in an “Important Documents” photo album. Leave a scanned copy of your passport with friends and family at home.

### **Immunizations**

Prior to travel, Elevate Destinations strongly recommends that you look into recommended immunizations for your time in Romania. Given that we are not a licensed Health Care provider, we cannot advise travelers on which immunizations they may or may not need. We recommend that all travelers do the following:

- a) Consult with a travel clinic or your personal physician regarding immunizations and other precautions you may need to take in order to participate in this journey. You will need to do this well in advance of your trip as some vaccinations require time to take effect, and you may need to allow time between a series of shots.
- b) Visit the [CDC website for Romania](#) to view recommended vaccines and medicines, travel health notices for the region and other tips for staying healthy and safe.
- c) Check that your medical insurance will cover you in Romania or purchase a supplementary medical insurance policy that will.

### **Other Health Considerations**

In general, we recommend a moderate level of physical agility. For the most satisfying experience, and in fairness to your fellow travelers, please note that this trip requires participants to:

- Walk at least one mile without difficulty on uneven surfaces
- Spend extended periods of time on their feet
- Climb sets of stairs without assistance
- Keep pace with an active group of travelers
- Spend time outside in weather that can be hot in the summer and cold and rainy in the winter
- Flexible and positive attitude in the case of sudden changes to the itinerary or weather—expect the unexpected!

## Medications

Always travel with medications in their original, clearly labeled containers and in your carry-on luggage. If carrying syringes or needles, be sure to have a physician's letter documenting their medical necessity and keep these handy when entering or exiting any of Romania's borders.

Elevate Destinations also recommends that all travelers make and print a list of medications and any existing health conditions to bring on your trip. You may choose to carry this on your person or give it to your guide. Having this list could be life saving in the unlikely case of an emergency.

## Safety Recommendations

Your guide will give you current briefings on safety while in-country, but here are some basic ground rules for safety while traveling:

- If you have time sensitive medication including epi-pens and inhalers, keep them on you at all times.
- Keep all valuables in the hotel safe.
- Avoid flashing money. Be mindful of your belongings at all times. Keep bags in front of you in crowds and on your lap when at restaurants.
- Pay attention and avoid walking around with your smartphone in hand.
- Be vigilant when crossing roads.
- Stick with the group.
- Always make sure that others know of your whereabouts and movements.
- Avoid street protests or large gatherings.
- Do not wear expensive or sentimentally valuable jewelry while traveling.
- Let your guide know if you have any safety concerns.
- We encourage you to [register with STEP](#) (see below).

### Smart Traveler Tip!

We recommend that all travelers from the USA sign-up for the State Department's Smart Traveler Enrollment Program (STEP)! This is a free service provided by the U.S. Government to U.S. citizens who are traveling to, or living in, a foreign country. STEP allows you to enter information about your upcoming trip abroad so that the Department of State can better assist you in case of an emergency. Enrolling in this program has enormous benefits in case of an emergency while abroad:

- You will receive information from the Embassy about safety conditions in your destination
- Enrolling lets the U.S. Embassy in that country know that you are there and helps them contact you in an emergency, whether natural disaster, civil unrest, or family-related.

## Communications

**Wi-Fi:** In most hotels in Romania, Wi-Fi will be available. Speed, bandwidth, and availability are typically good but may be less reliable than you are used to, particularly in mountainous regions. Often, connection is stronger in the lobby of hotels than in the rooms.

**International Calls:** If you are in Romania and trying to reach a number in the U.S., dial 00 before dialing the country code for U.S. (+1) + local number.

*The country code for Romania is +40. If you are in the U.S. and trying to call Romania, dial 011 + 40 + local number.*

**Staying connected:** Here are the most common methods for making local/international calls:

1. **Smartphone apps:** WhatsApp is the most widely used app for communicating (works on both Wi-Fi and cellular). Remember to download the app *before* you travel (to download, click [here](#))!
2. **Getting an international calling package:** Setting up international coverage from your cell phone provider for the duration of your trip is often the simplest option and the best to avoid roaming charges, or check if your phone plan automatically covers you in the region.
3. **Use a local phone / SIM card:** This is a good option for making calls within Romania as international calls can get expensive. Local SIM cards are inexpensive, can be found at a variety of stores, and often have pay-as-you-go plans where you can “top up” your credit for use in the country. Please be aware of any requirements your phone has in order to accept the local SIM cards (i.e. size of SIM card, jailbroken, etc). This will change your phone number for the duration of time you have a foreign SIM card in your phone.

## Essential Travel Documents

In case of emergency, it is advisable to record all of your important information on one sheet of paper, photocopy it, and distribute a few copies in your luggage and among relatives or friends at home. Also email a scanned copy to yourself. Take a photo of these documents and save them in an “important travel document” photo folder on your phone so that you can access these documents electronically.

*These are the documents you should have printed and with you during your travel:*

- Passport - original and photocopy
- International flight itinerary or e-tickets
- Address and phone numbers of the hotels where you are staying
- Medical/travel insurance policy details and 24-hour emergency number

- Evacuation insurance ID card (provided to you by Elevate Destinations)
- Emergency Contact List (provided to you by Elevate Destinations)
- Contact information of relatives/friends and your primary care physician to be contacted in an emergency
- List of current medical needs and medications in case of an emergency

## Money

The local currency in Romania is the Romanian Leu (RON), though EUR, USD, and GBP are also commonly accepted. Generally speaking, in Romania you will find credit cards are preferred for payment, though it is good to have some cash with you.

Click [here](#) to see the current exchange rate. Please note the following denominations below:

- **Bank Notes:** lei1, lei5, lei10, lei50, lei100, lei200, lei500
- **Coins:** Bani1, Bani5, Bani10, Bani50

The local currency you may need during your stay in Romania can be obtained at authorized facilities (such as ATMS, hotels, banks and foreign exchange bureaus). In general, we suggest that you limit the amount of money you convert into local currencies and exchange only what you think you will spend before leaving any foreign country. EUR, USD, GBP or other currency frequently used internationally can be easily exchanged in any town or city. Save all receipts from your currency exchange transactions. If you plan to exchange USD cash, the bills must be:

- New (printed in the last 5 years)
- In pristine condition (no rips, tears, smudges, markings, creases, etc)
- Larger denominations (\$50 and \$100 bills attract the best exchange rate)

For your extra personal costs and shopping, \$50-100 US per day is a good rule of thumb.

**ATM/Debit Cards:** You can use your debit card to withdraw money from ATMs. If you are paying merchants using your debit card, they will often ask for the PIN number. Please ensure you remember your PIN prior to traveling.

**Note:** We recommend traveling with 1-3 crisp \$100 bills in your carry-on luggage to exchange in the case that ATMs are not working for you, as well as some smaller bills for gratuity and other small exchanges

**Change:** Ask for smaller bills when you change money, or use your large bills at large shops to receive more change. In many cases, people (local vendors especially) don't have change.

**Credit Cards:** Credit cards (Visa or MasterCard preferred) are acceptable almost everywhere in Romania. Please note American Express and Discover cards are not commonly accepted.

**Gratuities:** Please check your online trip portal to find which gratuities are and are not covered in your trip cost. We recommend tipping your porters at the hotels and leaving behind cash in your room for the cleaning staff. For porters, 20 RON (about \$4 US) per bag is appropriate. For cleaning staff, we recommend leaving behind 30 RON (about \$6 US) per day. Please leave a tip for housekeeping each day because there may be different staff cleaning your room each day.

### Smart Traveler Tip!

Be sure you remember your ATM PIN numbers to withdraw cash at your destination.

Most banks and credit card companies do not flag international use as unusual, but if you use a more local bank it would be wise to notify them of your travel plans.

## In-country Info

### Time

Romania is in the Eastern European time zone (EET), which follows European Daylight Saving Time. In comparison to the United States:

- March 31 - October 26, 2024 (Eastern European Summer Time & US Daylight Savings): Romania is 7 hours ahead of Eastern Time (ET), 8 hours ahead of Central Time (CT), and 10 hours ahead of Pacific Time (PT).
- October 27 - November 2, 2024 (Eastern European Time & US Daylight Savings): Romania is 6 hours ahead of Eastern Time (ET), 7 hours ahead of Central Time (CT), and 9 hours ahead of Pacific Time (PT).
- November 3, 2024 - March 8, 2025 (Eastern European Time): Romania is 7 hours ahead of Eastern Time (ET), 8 hours ahead of Central Time (CT), 10 hours ahead of Pacific Time (PT).

### Electricity

Romania uses a standard of 230V, 50Hz, and plug types C and F. To keep your electronics up and running, we suggest purchasing a universal plug or adapter. Because the voltage in Romania is 230V and the U.S. is 100-120V, you may need a voltage converter for any small appliances you plan on bringing, such as a CPAP machine. This would not include phone chargers, as they usually have an internal converter.

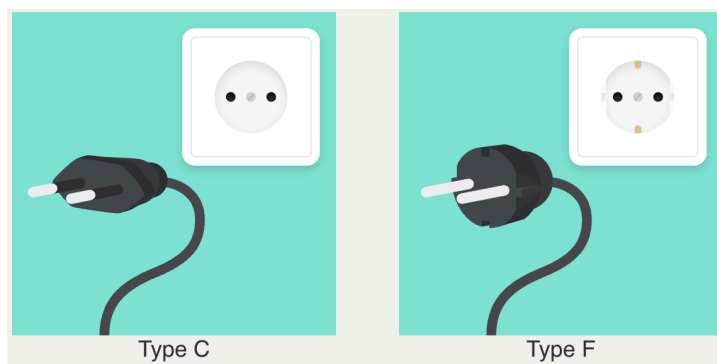



### Smart Traveler Tip!

Download a conversion app, such as [Units Plus](#), for things like currency, temperature, time, and distance while traveling.

## Water & Food Safety

Tap water is safe to drink in Romania unless otherwise mentioned by your guide. Bottled water is popular and common.

Elevate Destinations encourages travelers to pack a reusable water bottle to fill up with clean drinking water. Clean drinking water and optional drinks will be supplied at all meals and water will be available in the vehicle(s).

## Waste Disposal

Keep in mind that much of the world's waste disposal systems are not as advanced as you might be used to. Oftentimes, landfills are adjacent to conservation land or trash is burned. To minimize your impact, please consider the following guidelines:

- Leave no trace. Everything that you bring with you should go home with you.
- If you plan on shopping, make sure that you have extra room in your luggage or an extra bag to check on your way home (don't dump items to make room).
- Avoid packing with plastic bags and instead purchase reusable packing cubes, cloth bags, and reusable toiletry bags.
- Bring a reusable water bottle that you can refill.
- Remove packaging or tags of any newly purchased items before you go

## Local Cuisine

Romanian cuisine represents a true melting pot of Eastern European flavors, filled with stews, meats, potatoes and pickled vegetables, sour cream, and hardy pancakes and breads. Street food is common and delicious, and many types of international food are available in the large cities.

Romanians are often unaccustomed to vegan and vegetarian diets, however the large majority of Romanians are Eastern Orthodox Christians who practice *mancare de post*, or religious fasting that involves removing of all the animal products from their meals (meat, dairy products or eggs). This typically happens during Lent, but fasting food can be requested year-round.

Much like the rest of Europe and other countries with Latin influence, Romania is also well known for its beer and wine, with over 2000 years of history making wine.

Here are some common Romanian dishes that you may try during your trip:

- **Bulz:** Polenta is common in Romania, and this particular polenta dish is roasted and filled with two kinds of cheeses, bacon, and sour cream.
- **Ciorbă de fasole:** A bean soup found throughout Transylvania and served in a bread bowl. It can be ordered with or without meat.
- **Papanashi:** A very popular dessert found in Cluj that consists of doughnuts covered in jam and sour cream
- **Kurtos kalacs:** Another popular dessert most commonly found in Cluj with Hungarian roots. This is a rope of pastry dough that is rolled into a cone and covered with cinnamon sugar.

## Weather Conditions

Romania has a temperate northern climate that is very seasonal. The winters (December through February) can reach temperatures below freezing and summer months (June through August) can reach up to 85°F. The country does not experience large amounts of rainfall, but there can be more precipitation and colder temperatures in the mountainous region of Transylvania.

Elevate Destinations will provide you with a suggested Packing List that has more specifics on the weather in Romania for the dates of your trip.

## Cultural Considerations

Experiencing different cultures and ways of life is one of the joys of traveling. Below are some major elements of daily life, culture, and customs in Romania that you may experience.

- **Demographics:** The majority of the Romanian population are ethnically Romanian and over 70% follow Romanian Orthodoxy. The two largest minority groups are Hungarians and Roma, the latter of whom were enslaved upon their arrival in Romania and who still face discrimination today.
- **LGBTQ+ Rights:** LGBTQ+ people are affected by laws and policies around the world. In Romania, consensual same-sex sexual are not criminalized, and there are no legal barriers to freedom and expression in place. For more information on LGBTQ+ rights and tools for LGBTQ+ travelers going to Romania, [click here](#).
- **Social Norms:** Romanians like to take their time and it is common to be 15 minutes late. It is also important to remain calm in your interactions in Romania, regardless of any frustrations, as anger is not well received and people can be sensitive to criticism.
- **Greetings:** Greeting in Romania is gender-specific. Men shake hands, while women who know each other kiss on the cheek twice, starting with the left cheek. Men and women

generally do not shake hands; they will kiss cheeks if they are familiar enough, or simply nod to acknowledge each other.

- **Scams:** It is good practice to look out for scams while traveling, especially around tourist areas and big cities. It's pretty easy to avoid if you know what to look out for. Be vigilant. Here are some tips to avoid theft and scams:
  - When walking, always wear your backpack in front. Wear your purse slung across your body and place your hand over the zipper area in front as you walk.
  - Carry a photocopy of your passport with you at all times. If a police officer (or anyone, for that matter) asks to see it, say that your passport is at the consulate and offer to give them the photocopy instead. Police sometimes try to bribe tourists by taking their passport and demanding money to give it back.

## Language

Romanian is the official language of Romania. It is an Eastern Romance language with Latin roots. English is commonly spoken in most major cities and towns.

We recommend practicing the phrases below. People will appreciate you attempting to speak in their language!

English Phrase	Romanian
Hello	<i>Buna ziua</i>
Good morning	<i>Buna dimineata</i>
Good evening	<i>Buna seara</i>
How are you?	<i>Ce mai faci?</i>
What's your name?	<i>Cum te cheama?</i>
That was great / delicious.	<i>Mi-a placut mult/ A fost delicios.</i>

## Photography

Romania is a beautiful country, and you will want to take lots of pictures. When photographing people, always ask permission first. This is a sign of respect, as the subjects of your photos have the autonomy to consent. You can do this with gestures or ask your guide to translate.

Always be considerate of anyone's desire not to be photographed. There are some places where photography is prohibited; these areas are usually marked. If you are uncertain about whether or not photography is permitted, your guide will be there to advise you.

If you would like some tips on ethical photography practices, check out our blog post, "[Nine questions to help decolonize your photography.](#)"

## Human Trafficking in Travel

Elevate Destinations has signed [The Code of Conduct for the Protection of Children from Sexual Exploitation in Travel and Tourism](#) (The Code) and expects all of its partners to refuse involvement, both direct and indirect, in the commercial sexual exploitation of children. A "child" is defined as a person younger than 18 years of age, according to the UN Convention on the Rights of the Child.

We encourage our travelers and suppliers to report the sexual exploitation of children. Information, even the smallest amount, can represent the missing piece of an ongoing investigation by law enforcement. If you are uncomfortable with leaving your name and contact information, you can report anonymously to law enforcement or NGOs. Report a concern [using this form](#); alternatively, you can email [protect@ecpat.net](mailto:protect@ecpat.net) to report sexual exploitation of children.

Read about Elevate's values & vision, our [sustainability commitment](#), our programs that give back and more on our website at [www.elevatedestinations.com](http://www.elevatedestinations.com). Our team members are always excited to share more on this topic. We acknowledge that to maintain truly sustainable travel products takes ongoing commitment. We continue to monitor our programs on the ground in order to improve them, and welcome your thoughts, feedback and encouragement!

## Responsible Travel Tips

Elevate Destinations takes pride in its leadership in the field of responsible travel. We take care in selecting our local partners that share our environmental and social values and are avid supporters of locals working in the tourism industry as they are both the most impacted and impactful players at the local level. All of your ground costs on this trip are carbon offset using [Native Energy's Carbon Calculator](#).

Here are a few tips that can help enrich your experience as a responsible traveler:

- **Keep an open mind:** Observe local customs and respect traditional cultures and people.
- **Language:** Learn a few basic greetings and “thank you” in the local language.
- **Local economy:** Support locally owned businesses, restaurants and other services. Shop from local artisans to promote traditional crafts and encourage contemporary arts.
- **Respect:** It is important to acknowledge the privacy and dignity of others and ask before photographing or filming people. Ask permission before entering sacred places, homes or private land, and take heed of local customs (i.e. remove shoes, hats, cover hair with shawl, etc). Please ask your guide if you are unsure; they are there to support your introduction to the culture!
- **Community and environment:** Contribute to organizations that support traditional cultures and protect the natural environment. Keep to designated trails and do not disturb plants and animals or their natural habitats.
- **Animal products:** Avoid purchasing crafts, clothing, furniture or other products that are derived from members of protected or endangered animal species.
- **Properly dispose of trash:** Avoid using plastic bags and try to minimize the use of other disposables. When traveling in areas away from cities, make sure to take out what you take in. Try using a reusable water bottle and treating your own drinking water when possible. Check out what our friends at [Travelers Against Plastic](#) are doing!
- **Don't feel pressured to give away money or material items:** You will likely encounter instances of poverty and people asking for donations. We try to discourage giving away money or items as it can actually accentuate an unequal relationship between visitors and locals. Additionally, children that receive money, gifts and sweets from you are encouraged to stick around for more rather than to be in school. As difficult as it can be to turn down direct requests, sometimes giving your friendship and respect to locals can be the best gift of all. If you want to help, consider giving to a trustworthy charity, non-profit, or local school.
- **Tip your housekeeping staff:** Many of the staff cleaning hotel rooms are on the bottom of the economic pyramid. Please consider leaving a tip before you check out. The equivalent of \$3-5 a day is appropriate. This is an easy way to ensure some of your money reaches the hands that need it the most.

#### **Smart Traveler Tip!**

In travel, especially in the developing world, things happen. Expect the unexpected! Keep an open mind, be flexible and enjoy the moment. Sometimes the best memories come out of the unplanned.